



Eleven bedroom country home in a rural location

exclusive to

SAUNDERS

richardsaunders.co.uk

High Road Chipstead CR5

Banstead Village - 4 miles

London - 16 miles

M25 - 2 miles

London by rail 45 minutes from Chipstead or

25 minutes from Coulsdon South

All times and distances are approximate

New to market this exceptional period eleven bedroom country house benefits from a well appointed interior and spacious ambiance. The property enjoys rural tranquillity of the North Downs whilst offering accessibility to both the M25 & M23 and Chipstead station which is a short drive away and has links to central London. Set in parkland grounds of over seven acres the property offers an outdoor heated swimming pool, tennis court and large driveway for multiple cars.

Available ?Vcj Vgn

Eleven Bedroom

Unfurnished

Swimming Pool

Tennis Court

Seven Acres Of Parkland Grounds

Price £1' 7%%pcm





Gross internal area (approx.)
 Total = 936 sq m (10075 sq ft)
 Main House = 577 sq m (6210 sq ft)
 Outbuildings = 220 sq m (2373 sq ft)

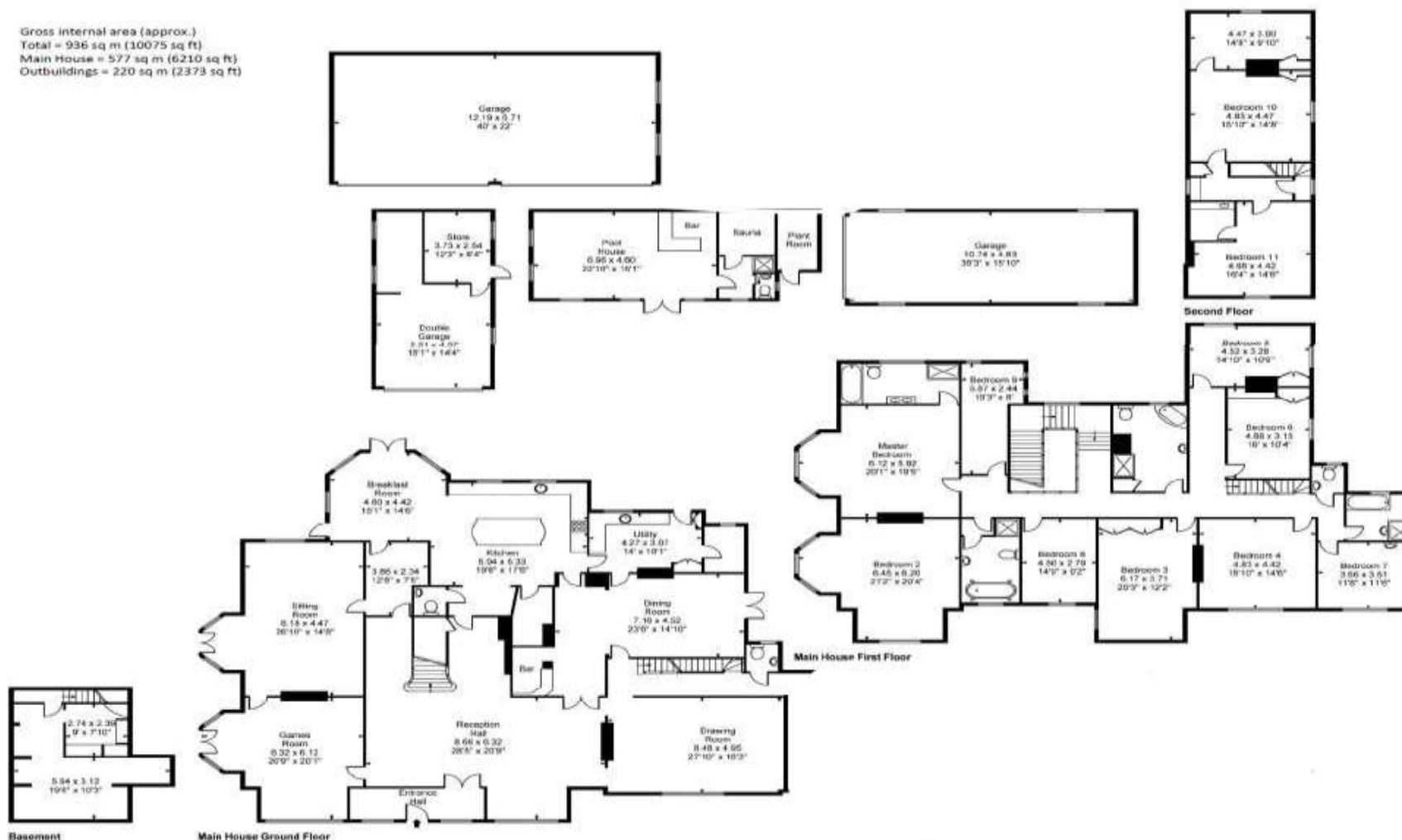

discover more at richardsaunders.co.uk



IMPORTANT NOTICE TO PURCHASERS: We endeavour to make our sales particulars accurate and reliable, however, they do not constitute or form part of an offer or any contract and none is to be relied upon as statements of representation or fact. The services, systems and appliances listed in this specification have not been tested by us and no guarantees as to their operating ability or efficiency are given. All measurements have been taken as guide to prospective buyers only, and are not precise. If you require clarification or further information on any points, please contact us, especially if you are travelling some distance to view.

Viewing
 Please call us to arrange
 a viewing appointment

1 Waterhouse Lane
 Kingswood
 01737 360000

2 High Street
 Banstead
 01737 363333

Residential Lettings
 All Areas
 01737 370700

SAUNDERS

richardsaunders.co.uk